

Training Manual: IG-Touch (FXv4) Interactive Panel

Table of Contents

The Panel's Key Functions	5
Remote	6
Home Screen	7
Note (Whiteboard)	9
Browser	15
Finder	16
Settings	18
EShare	19
Side Panel Functions	20
Section 1 – EShare Casting Connection Code	20
Section 2 – Android Control	21
Section 3 – Tools.....	21
The Floating Tool	24
Section 4 – Applications	25
Section 5 - Network Controls	28
Section 6 - Brightness and Sound	28
Section 7 - Display Controls	28
Section 8 - Power Off	29
Section 9 - Input Source	29
Connecting Devices with Cables	30
VGA Connection	30
HDMI Connection	30
Using Finger or Panel's Pen	31
Cleaning the Panel	31
Cleaning the Screen	31
Cleaning the Frame	31
Appendix A – EShare	32
Accessing EShare on the Panel	32
Updating EShare's Settings	33
Moderator Control Center	35
Displaying Connected Devices	37
Display Group Settings	38
BYOM	38
Cloud Broadcast	39
WebCast	39

Using EShare with a Laptop / Desktop	40
Installing EShare Client on a Laptop or Desktop	40
Connecting the Panel and a Laptop/Desktop Device	41
Share Screen	42
Extend Screen Mode	43
TV Mirror	44
Using EShare with a Mobile Device.....	46
Installing EShare Client on a Mobile Device	46
Connecting the Panel and a Mobile Device	47
Share Screen	48
TV Mirror	50
Photo	52
Audio/Video	53
Doc	54
Camera	55
Remote	56
Disconnecting the Panel and a Mobile Device	58
Screen Sharing using Apple AirPlay	59
Appendix B – Adding Additional Users	61

The Panel's Key Functions

Function	Description
USB Ports	<p>There are 4 USB-A ports on the FXv4 panel. Two are on the front bottom left-hand corner of the panel, and two are located on the bottom left-hand side.</p> <p>A USB-C port is located on the front bottom left-hand corner of the panel and one on the bottom left-hand side.</p>
Secondary Switch	<p>The secondary power switch is located on the right-hand side of the panel.</p>
Power Button	<p>Once the secondary power switch has been turned on, firmly press the button on the left-hand side of the panel to turn it on.</p> <p>A White light indicates the panel is turned on and a Red light indicates the panel is off.</p> <p>If the button is flashing white and red, the display is off, however the system is in standby mode.</p> <p>Press the button to take it out of standby mode.</p>
Remote Control	<p>Ensure the remote is pointed directly at the sensor located on the bottom left-hand corner of the panel.</p> <p>The coloured buttons in the centre of the remote can be used to:</p> <ul style="list-style-type: none"> Red - Enable or Disable the Front Button and the Touch. Green - Enable or Disable the Front Button. Yellow - Enable or Disable Touch. Blue - Pop out or close the screen zooming tools.
Panel Pens	<p>Two pens are supplied with the panel and can be used simultaneously.</p>
External Inputs	<p>Connect an external PC/Mac/iPad/Tablet on the lower left-hand side.</p>

Remote

Ensure the remote is pointed directly at the sensor located on the bottom left of the panel.



Home Screen

The HomeScreen displays when the panel is turned on and features five applications: Note (Whiteboard), Browser (Chrome), Finder (File Management), Settings, and Screen Casting (EShare).

The centre of the panel displays the current date and time, a Google search bar, quick access to Google apps and the Google Play Store. Icons are displayed on the top left and right-hand sides.

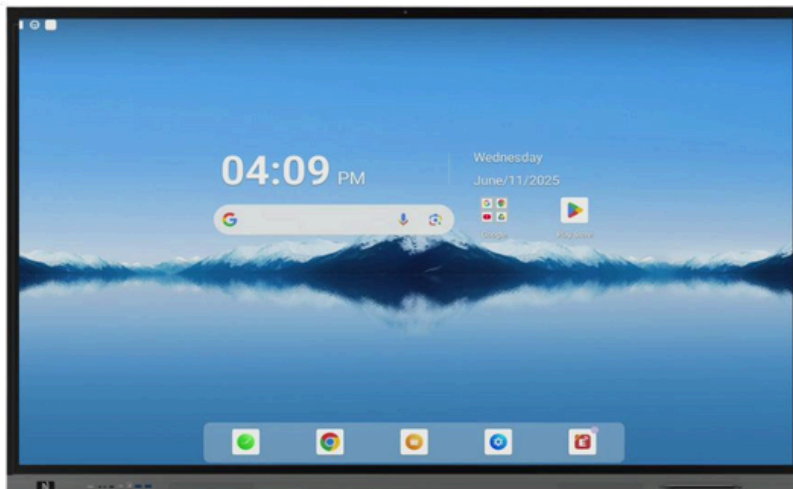

Swiping down from the top of the panel displays the Android Control panel which shows quick access to the Internet, Bluetooth, Do Not Disturb, Auto-rotate, Airplane mode, Screen record, Quick Share, Screen Cast (if running) and USB (if inserted).

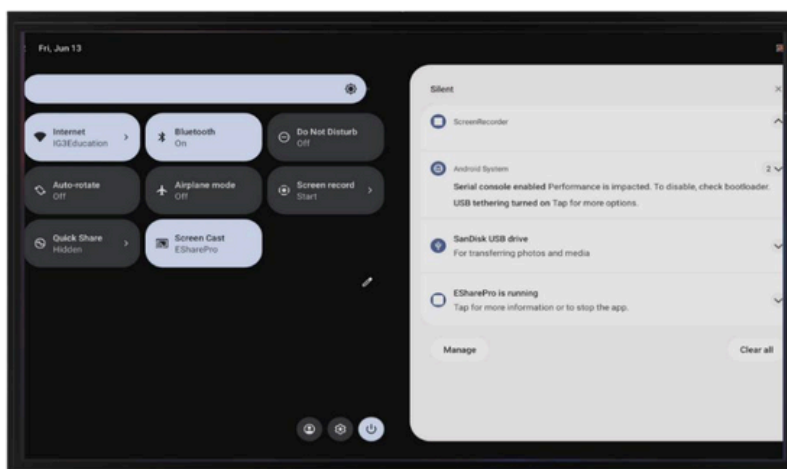

Swiping up from the bottom of the Android Control panel returns to the Home Screen.

Swiping up from the bottom of the Home Screen displays a list of all apps installed on the panel.

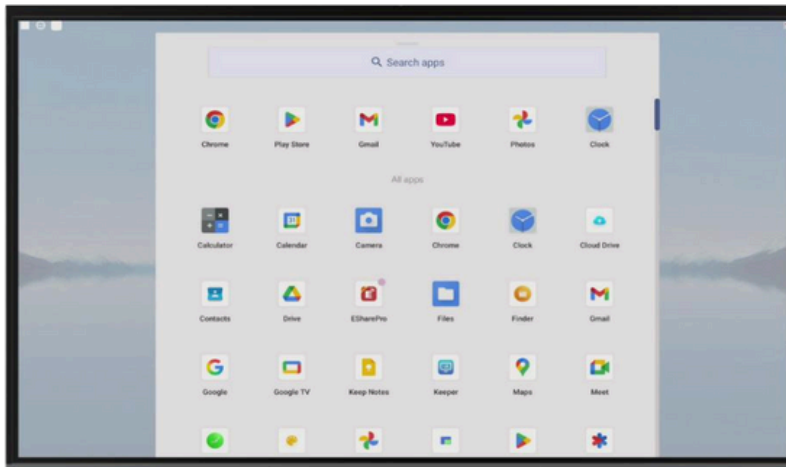

Identical screen Side Panels are located in the middle of both the left-hand and right-hand sides of the panel. Touch either bar to display the Side Panel functions. **(Refer to Page 20 for more information).**

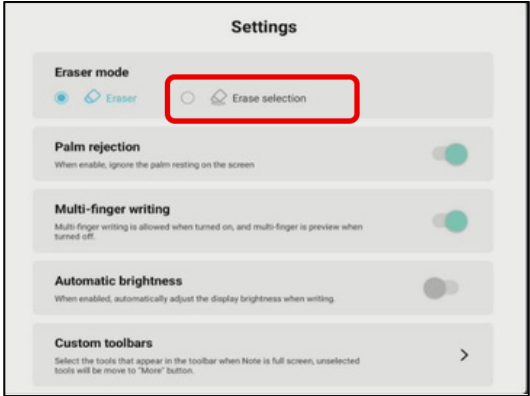
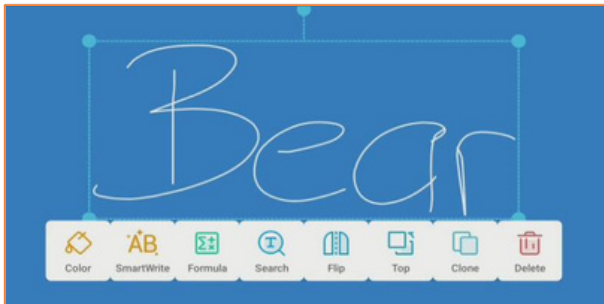

	<p>1.9 - Settings opens Note's settings.</p> <p>Select Erase Selection to add additional Erase options.</p> 
<p>2. Exit</p>	<p>To exit Note, touch the Exit icon.</p>
<p>3. Share</p>	<p>To share the Note page with a device:</p> <ul style="list-style-type: none"> • Touch the Share icon. • Scan the QR code. • The image is automatically downloaded onto the device. <p>Note: The panel and the device must be on the same Wi-fi network.</p>
<p>4. List</p>	<p>To display multiple instances of Note.</p>
<p>5. Select</p>	<p>To select an object, touch the Select icon.</p> <ul style="list-style-type: none"> • Objects can be selected by: <ul style="list-style-type: none"> o Using a pen or a finger to draw a circle around an object. o Tapping the outer edge of the object. • Objects can be moved by holding and dragging them to the desired location. • To resize an object, drag the opposite corner dots of the object to the desired size. • The object can be edited by: 

- o Changing the colour.
 - o Changing the written object to a typed object
 - o (SmartWrite).
- Searching the internet for additional information.

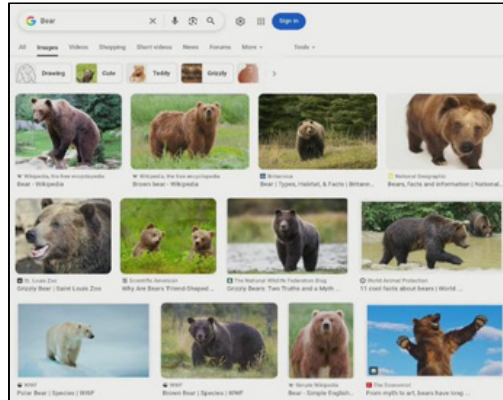

- o Filling the object with a colour.
- o Flipping horizontally or vertically.
- o Altering the position of the object.
- o Cloning the object to create another copy.
- o Deleting the object.

The first time SmartWrite is selected, the handwriting recognition language must be chosen.



6. Pen

To enable the writing tool, touch the **Pen** icon.
• Tap again to open the menu.

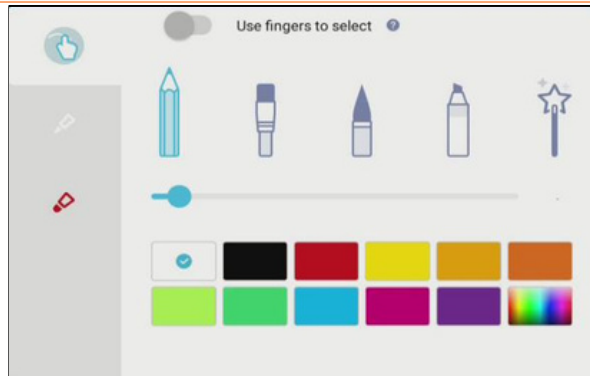

- Select one of the two available pens or the finger option.
- Select the desired colour, line thickness and writing tool.
- The pens can be flipped to write on either end.
- The **Magic Wand** converts a drawn shape into an object.

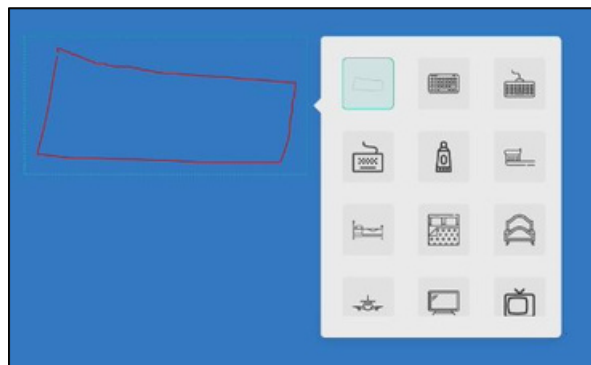

Slide **use fingers to select** to use your hand to select objects in preference to writing.

To access the eraser, touch the **Eraser** icon.

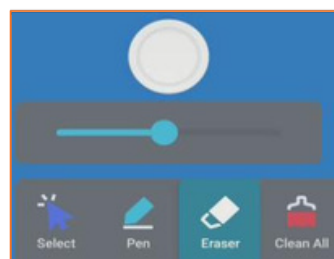

7. Eraser

- Touch the **Eraser** icon again to change the size of the hand gesture eraser. The hand gesture icon does not erase objects.

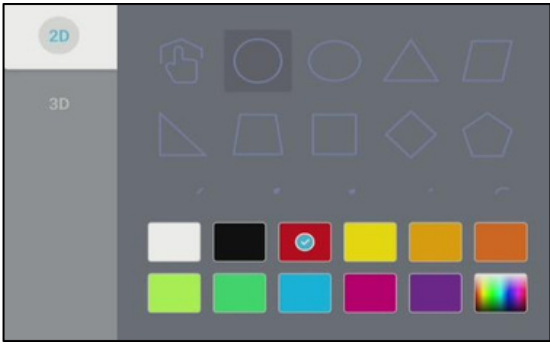
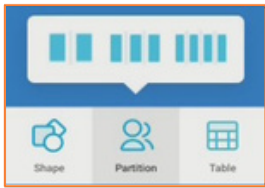

The Object Eraser is located in Menu > Settings. The object eraser will erase both text and objects.

8. Clean All	To delete all contents on the page, touch the Clean All icon.
9. Ruler	Touch the Ruler icon to display a variety of measuring tools: a ruler, set squares and a protractor.
10. Shape	<p>To draw 2D or 3D shapes or lines, touch the Shape icon twice.</p>  <ul style="list-style-type: none"> • Select the shape, line and colour. • Place the pen in the starting location and drag the shape to the desired size. • Use the hand image on the 2D menu to freehand draw 2D shapes.
11. Partition	<p>To split the screen so that it can be used by two, three or four people at once:</p> <ul style="list-style-type: none"> • Tap the Partition icon. • Select the number of partitions. 
12. Table	Touch the Table icon to create a table up to 6 x 6 in size. The height and length of a cell will resize to the size of the cell's contents. Use the Select tool to edit the table.
13. Browser	Inserts a Google browser into the whiteboard.
14. Mind map	Touch the Mind map icon to display a Mind map on the screen. Additional branches can be added.
15. More	Access additional tools such as Sticky Notes, Preview, Grid and Formula.

	
15.1. Sticky Notes	<p>Touch the Sticky Notes icon to display a Sticky Note on the screen.</p> <ul style="list-style-type: none"> • The colour can be changed to Blue, Yellow, Red and Green. • Enter the text on the displayed keyboard and press OK. • The Sticky Note displays on the upper right-hand side of the screen.
15.2 Preview	<p>To preview the page, touch the Preview icon. Use your hand to resize (expand to obtain clarity or reduce to obtain more room) or move the contents of the page.</p>
15.3 Grid	<p>Touch the Grid icon to display a four lined grid.</p>
15.4 Formula	<p>Use the inbuilt calculator to solve mathematical equations.</p> 
16 Undo	<p>To Undo the last action.</p>
17 Redo	<p>To Redo the last action.</p>
18 Add	<p>To Add a new page.</p>
19 Previous	<p>To display the Previous page.</p>
20 Page Number	<p>To display a list of all pages, tap the page numbers. A menu displaying all pages appears on the right-hand side. Touch the page to open that page or X to permanently delete the page.</p>
21 Next	<p>To display the Next page.</p>

Browser

To access Chrome on the panel, select the **Chrome** icon on the Home screen or in Apps on the Side panel.

- The Browser can be used with or without a Google account.
- Touch the **Search Bar**.
- Enter the search criteria or the website on the pop-up keyboard.
- Touch **Enter**.

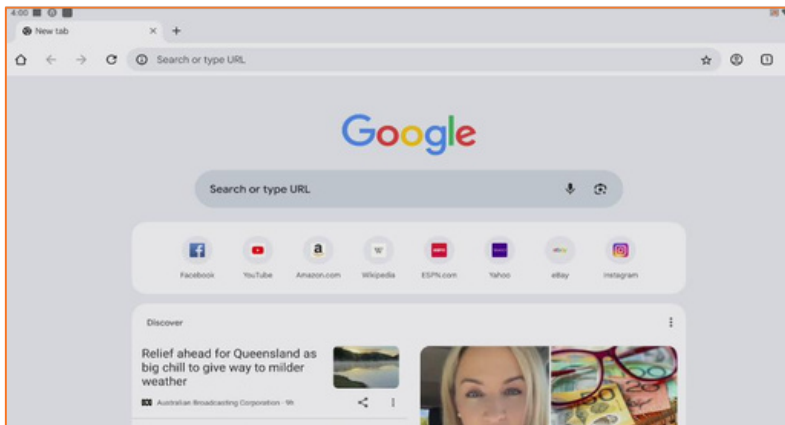

Finder

Finder is a file management application used to access DOCX, PPTX, XLSX, PDF, audio and video files stored on the panel (Storage), USB or from the cloud. USBs can be inserted into one of the ports on the bottom left-hand corner or left-hand side of the panel.

To open Finder, touch the **Finder** icon on the Home Screen or in Apps on the Side panel. The panel's default folders will display in grid view and cannot be removed.

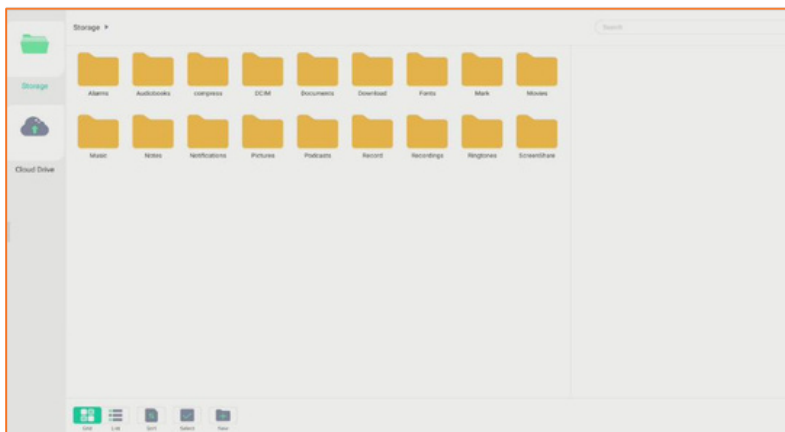

The following functions are available in Finder:

Tool	Description
Search Files	<ul style="list-style-type: none"> • Touch the Search Bar on the top right-hand side of the screen. • Enter the filename from the pop-up keyboard.
Grid / List View	<ul style="list-style-type: none"> • Choose between displaying folders in either the Grid or List view. • Touch either Grid or List on the toolbar to change.
Sort Files	<ul style="list-style-type: none"> • Touch Sort on the toolbar. • Folders and Files can be sorted by Name, Time, Size or Type.
Select Files or Folders	<ul style="list-style-type: none"> • Touch Select on the toolbar. • Select the file(s) or folder(s). • Touch Select All on the toolbar to select all files or folders.

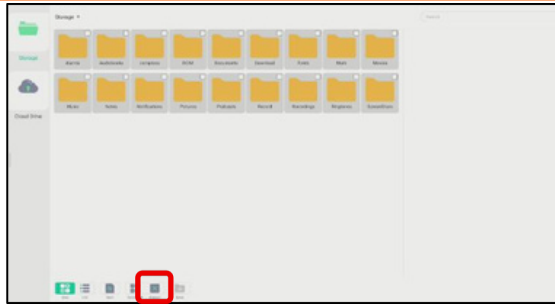

- Once a file(s) or a folder(s) is selected, an additional toolbar displays in the bottom middle of the screen.

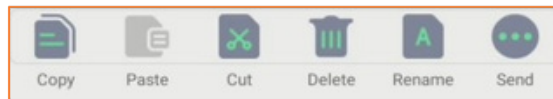

New Folders	<ul style="list-style-type: none"> • Additional folders can be added by touching the new folder icon on the toolbar.
Cut/Copy and Paste	<ul style="list-style-type: none"> • Select the file(s) or folder(s). • Touch the Cut icon to cut, or • Touch the Copy icon to copy. • On the left-hand side pane, select the location folder: • Storage, USB or Cloud Drive. • Touch the Paste icon to paste.
Delete	<ul style="list-style-type: none"> • Select the file(s) or folder(s) to delete. • Touch the Delete icon.
Rename	<ul style="list-style-type: none"> • Select the file(s) or folder(s) to rename. • Touch the Rename icon. • Enter the new name from the pop-up keyboard.
Send	<ul style="list-style-type: none"> • Select the file(s) or folder(s) to copy to another device. • Touch Send. • Select the desired device. <p>The file(s) or folder(s) will be copied to the selected device.</p>

Settings

To access Settings, touch the **Settings** icon located on the Home Screen or in Apps on the Side Panel. Many of the settings are pre-configured and cannot be changed.

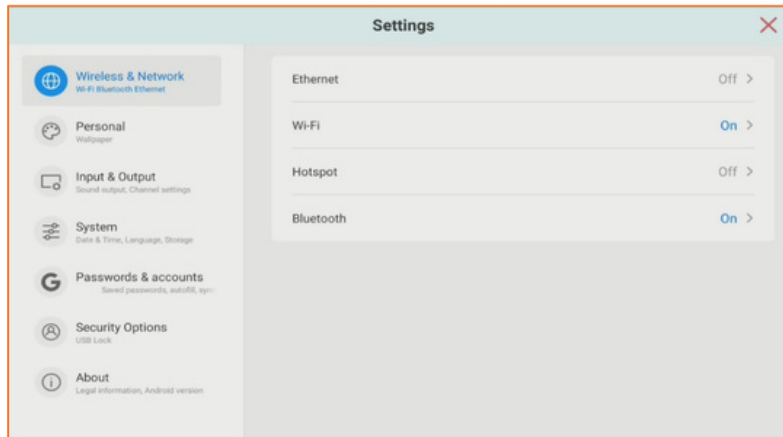

The following settings are available to configure:

Wireless & Network:

- Connect to the schools' network via Wi-Fi or Ethernet.
- Connect to the panel via the built-in Hotspot.
- Attach a personal keyboard or mouse via Bluetooth.

Personal:

- Change the Home Screen wallpaper to the school's logo or another picture.
- Activate the Floating tool.
- Use a long press to turn the screen off.

Input & Output:

- Manage the panel's devices such as sound, microphone, input, and external source display settings.

System:

- Change date and time if required.
- Change the language and keyboard.
- Manage the Startup and Shutdown features.

Passwords & accounts:

- Save passwords to Google Password manager.
- Activate the Auto-fill service.
- Automatically sync app data.

Security Options:

- Lock USBs.

About:

- Details about the panel's specs.

EShare

EShare is a wireless display solution preloaded on interactive panels. It provides wireless display and touch control for Windows and Mac laptops and desktops, and wireless display for iPads, tablets, and mobile phones.

Up to 16 devices can be displayed simultaneously and up to 50 devices can be connected.

EShare requires network access, and all devices must be connected to the same subnet or able to access the Panel's Hotspot.

There are three main features available with EShare:

1. **Screen Sharing** - Up to 16 devices (PC/Mac/Mobiles/Tablets) mirrored on an interactive panel at one time.
2. **TV Mirror** to view the panel's contents on a device.
3. **Remote** to control the panel from a mobile device.

To begin wireless sharing, EShare must be installed onto either:

- a laptop/desktop (**refer to page 40 for information**), or
- a mobile device (**refer to page 46 for information**).



Side Panel Functions

The SidePanel displays information on:

1. EShare Casting Connection Code
2. Android Control
3. Tools
4. Applications
5. Network Controls
6. Brightness and Sound
7. Display Controls
8. Power Off
9. Input Source

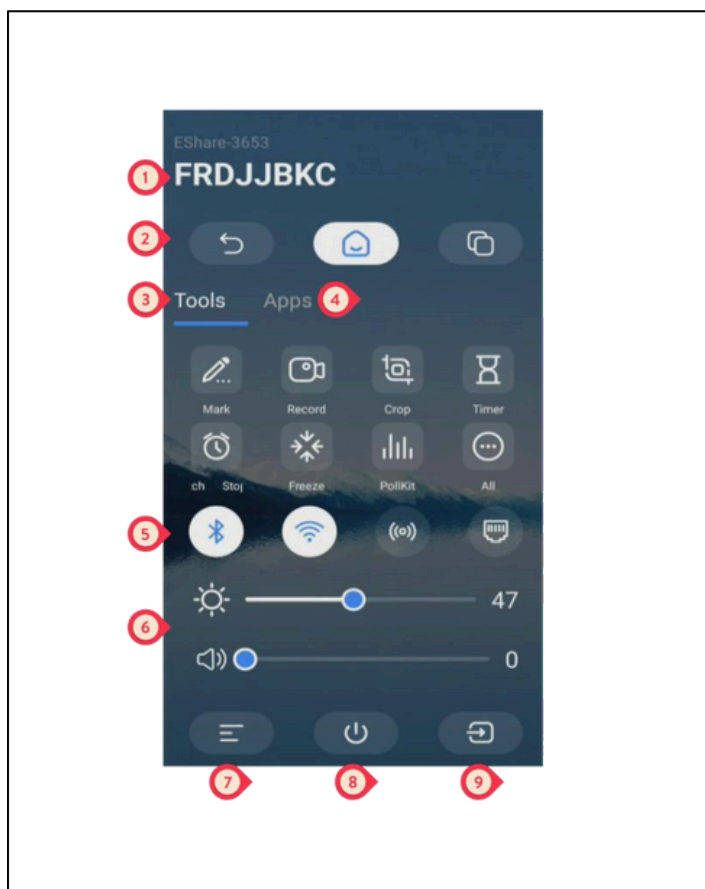

Section 1 – EShare Casting Connection Code

The top of the Side Panel displays the code for connecting a device to EShare (Screen Casting).



Section 2 – Android Control

Section 2 contains three icons which control the movement on the panel.

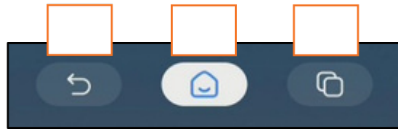

1. Return 'BACK' to the previous screen.
2. Display the Panel's Home Screen.
3. Opens Task Manager to view open screens, documents or applications.
Screenshots can be taken of the open tasks and can be shared, printed, edited, or saved on a Google drive.

Section 3 – Tools

The third section of the Side panel displays numerous tools to enhance the student's learning.

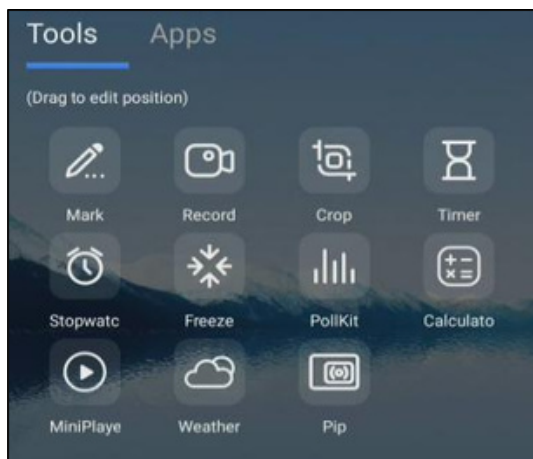

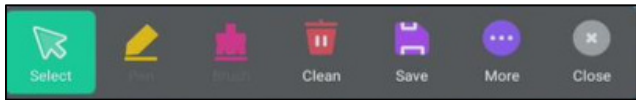
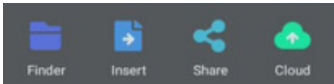
Application	Description
Annotation Tools (Mark)	<p>The Annotation tool is used to write, and erase text and objects.</p>  <p>Images can be saved on the local panel in a folder named Mark, inserted into the whiteboard or shared directly to a device via a QR code.</p> 

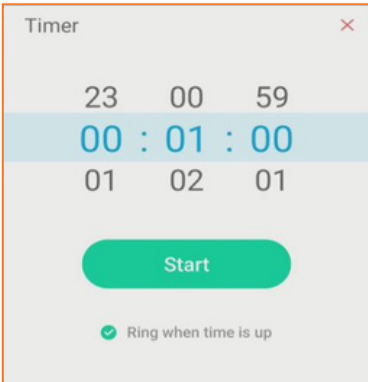
Record	Records the movement on the Panel.
Crop	The Crop tool is used to crop and save an image displayed on the panel. The full screen or part of the screen can be saved and the image inserted into the whiteboard.
Timer	<p>Opens a Countdown Timer. A bell will ring by default when the time is complete, and the timer can be changed to display the full screen.</p>  <p>The screenshot shows a 'Timer' window with a close button (X) in the top right. The time is set to 23:00:59, with the current time 00:01:00 highlighted in blue. Below the time is a green 'Start' button and a checked checkbox for 'Ring when time is up'.</p>
Stopwatch	Opens a Stopwatch .
Freeze	Freeze freezes the screen. This allows for one application or file to display on the screen and another on a device. Freeze can also be used to Zoom in or out.
PollKit	PollKit is an interactive solution for questioning students. Students answer questions by scanning a QR code. The questions can be asked verbally. Students answer on their device. Statistics of the results are displayed upon the panel and can be inserted into the Whiteboard.
All	Additional tools such as a Calculator, Miniplayer, Weather and Pip are available.
All - Calculator	Opens a Calculator.
All - MiniPlayer	Plays a video.
All - Weather	Tap City Setting to enter the name of the city.

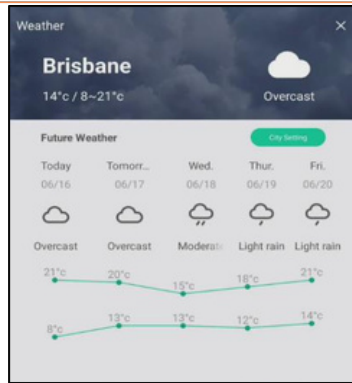

An 5-day overview of the weather displays.

Pip

Program in Program displays the contents of a laptop to be open in a window on the Android device thus allowing additional tools or apps to also be accessed.

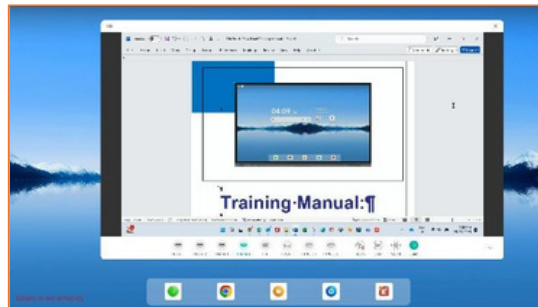

The Floating Tool

The Floating Tool activated in the **Settings > Personal** menu and is accessed on most screens by pressing two fingers on the panel. It displays shortcuts to the Home Screen, the Whiteboard (Note), Settings, Task Management and Annotate.

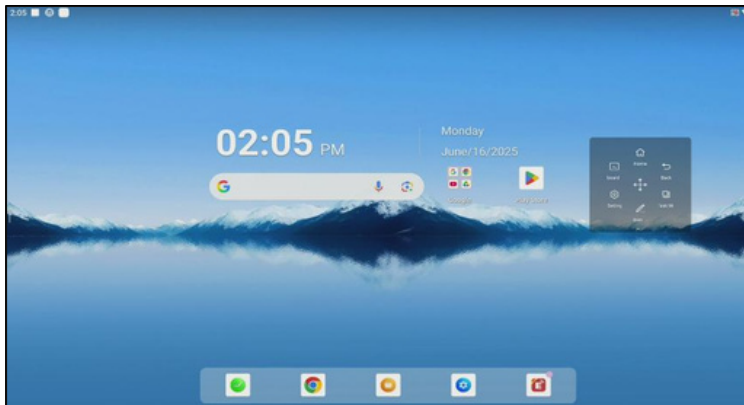

Application shortcuts can be added to the second screen.



Move the Floating Tool to be it on the top, bottom or sides of the panel for quick access.



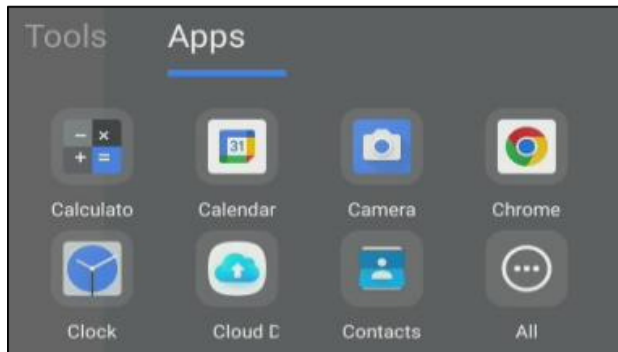

Section 4 – Applications

There are numerous applications located under Apps on the Side panel. Majority of these are in the All menu.

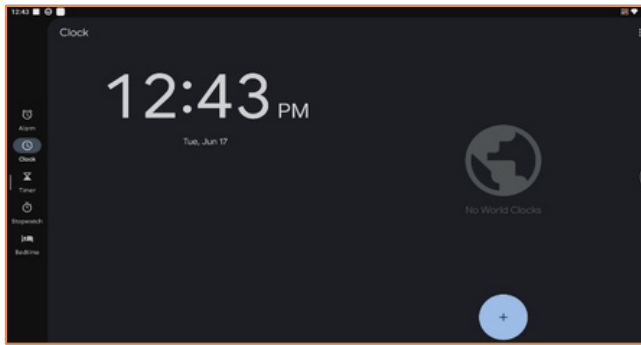

The following applications are available:

Application	Description
Calculator	
Calendar	Opens a calculator .
Camera	Opens a Google calendar .
Browser	Connect a Webcam to the panel.
(Chrome)	Refer to Browser on page 15 of the manual for more information.
Clock	Set Alarms, display the current local time and the time in other locations, use the countdown timer and stopwatch and set wakeup and bedtime schedules. 
Cloud Drive	Touch Cloud Drive to access either your Google Drive or OneDrive account.
Contacts	Access your contacts .

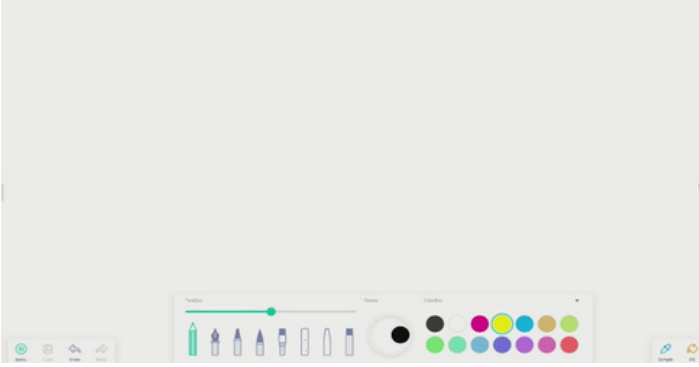
All -	Displays a list of all apps including Google Apps.
All - EShare	<i>Refer to EShare on page 19 of the manual for more information.</i>
All - Finder	<i>Refer to Finder on page 16 of the manual for more information.</i>
All - Keeper	<p>The Keeper Home Screen displays the memory usage, the garbage usage and available storage.</p>  <ul style="list-style-type: none"> • Apps displays all Apps, the size and version. • Network checks the Intranet, Extranet and DNS connect states and displays a link to do a speed test. • Sensor displays a list of optional sensors.
All - Note	<i>Refer to Note on page 9 of the manual for more information.</i>
All - Palette	<p>To open the Palette, touch the Palette icon.</p> <ul style="list-style-type: none"> • Select the pen type and colour. • Touch Fill in the bottom right-hand side to change the background colour. • Touch Menu on the bottom left-hand side to save the palette, import photos or share the palette by scanning the QR code. 

All - Photos	All Photos and Videos stored on the panel and connected USBs are displayed.
All - WPS Office	WPS Office accesses DOC, DOCX, PPT, PPTX, XLS, XLSX, PDF or TXT files stored on the panel or USB. Files can be annotated, edited, and saved.
All - YouTube	Opens YouTube.

Section 5 - Network Controls

There are four Network Controls:

1. Bluetooth
2. Wi-fi
3. Hotspot
4. Ethernet

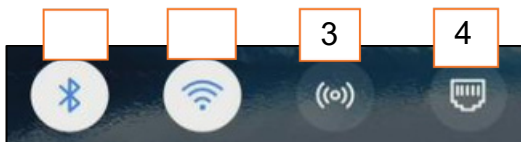

They are white when turned on and black when not active.

Section 6 - Brightness and Sound

Slide the bar to increase or decrease the Brightness and Sound.

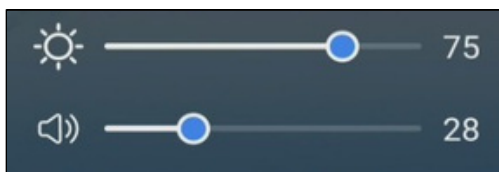

Section 7 - Display Controls

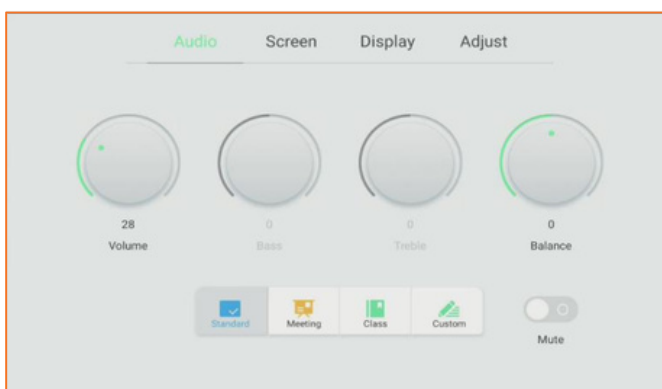

The display controls are:

- **Audio** – automatically adjusts for standard, meeting, class or custom.
- **Screen** – set controls for Eye Care, Pixel Shift, AutoLight, and SaveEnergy.
- **Display** – Change to screen colour for Standard, Cold or Warm visuals.
- **Adjust** – Adjust horizontal, vertical or phrase.

Section 8 - Power Off

Change the power options to turn the panel off, place in standby mode or restart.

Section 9 - Input Source

The **Input Source List** screen displays connected devices such as the panel (Android), connected laptops or desktops and the inbuilt PC (if purchased). Connected devices display with a green dot to the left of their name.



For additional information on connecting devices, refer to page 30.

Connecting Devices with Cables

Laptops or desktop computers can be connected to the panel using the supplied cables:

- HDMI
- USB-A to USB-B

VGA Connection

If connecting using a VGA cable, an additional audio cable is also required. To connect successfully, the supplied USB-A to USB-B cable is also needed to enable panel's touch feature. The cable ports are located on the lower right-hand side of panel and are clearly labeled.



HDMI Connection

If connecting with the HDMI cable, the USB-A to USB-B cable is also needed to enable the panel's touch feature. The cable ports are located on the lower right-hand side of panel and are clearly labeled.



Using Finger or Panel's Pen

The Interactive Panel is a 20 point-touch screen.

Both the finger and the pens can be used to access applications, write text, draw, and select objects.

When using the pen, keep it at a right angle to the screen.

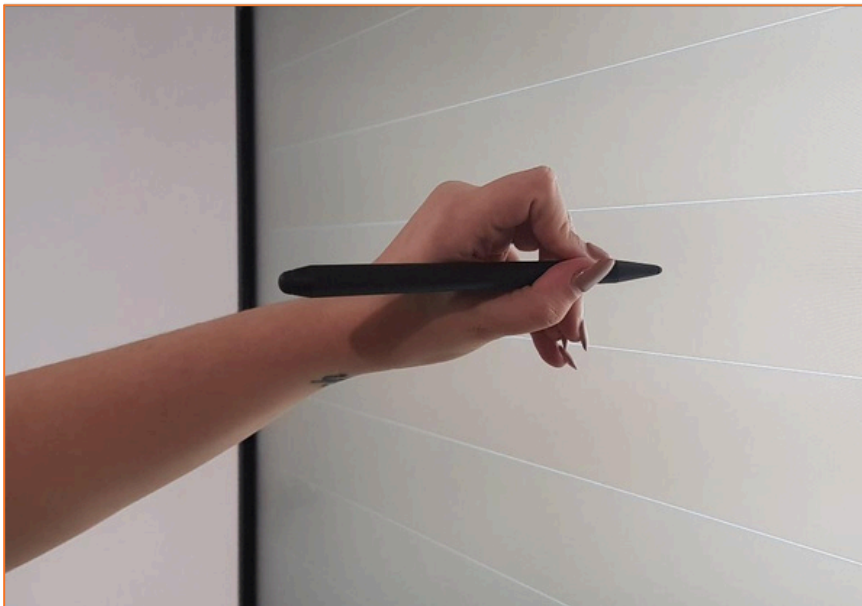

Cleaning the Panel

Maintaining and cleaning your panel can avoid many early faults and keep the panel looking like new. Overtime, the interactive panel will accumulate finger marks on the screen from regular use.

Cleaning the Screen

It is important to implement regular cleaning routines:

1. Use a microfiber cloth.
2. Dampen the cloth with warm water.
3. Twist the cloth to completely remove all moisture before wiping the screen.
4. Wipe in a horizontal motion.
5. Ensure all parts of the screen are covered.
6. Use a dry microfiber cloth to dry the screen.

Do NOT use chemicals or liquid/water to clean the panel as this will eventually wear down or ruin the coating.

Cleaning the Frame

Regularly dust the panel with a dry microfiber cloth to keep it dust free.

Appendix A – EShare

EShare is a wireless displaysolution preloaded on interactive panels. It provides wireless display and touch control for Windows and Mac laptops and desktops, and wireless display for iPads, tablets, and mobile phones.

Up to 16 devices can be displayed simultaneously and up to 50 devices can be connected.

EShare requires network access, and all devices must be connected to the same subnet or able to access the Panel's Hotspot.

There are three main features available with EShare:

1. **Screen Sharing** - Up to 16 devices (PC/Mac/Mobiles/Tablets) mirrored on an interactive panel at one time.
2. **TV Mirror** to view the panel's contents on a device.
3. **Remote** to control the panel from a mobile device.

To begin wireless sharing, EShare must be installed onto either:

- a laptop/desktop (*refer to page 40 for information*), or
- a mobile device (*refer to page 46 for information*).

Accessing EShare on the Panel

To access EShare:

1. From the Home Screen, tap EShare.

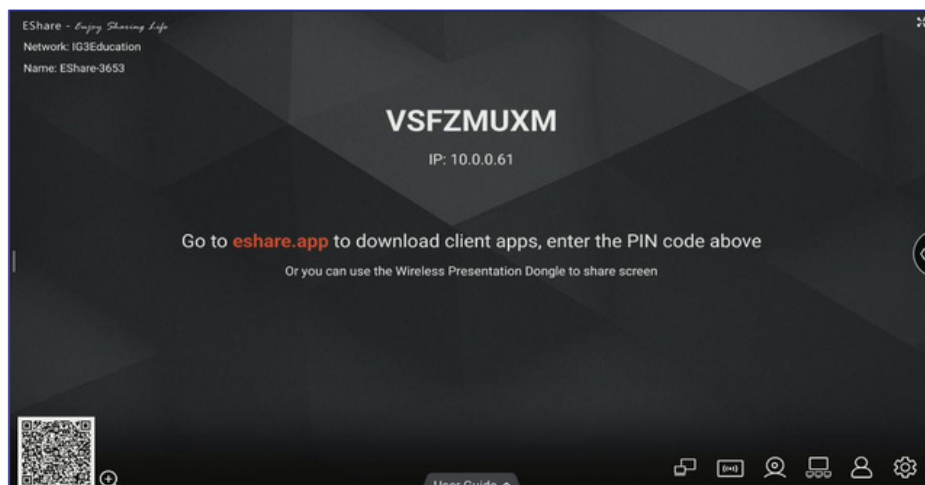

Updating EShare's Settings

EShare's settings can be changed to suit the organisation's requirements.

To update EShare's settings:

1. Tap **EShare** on the Home Page.
2. Tap the **Settings** icon.

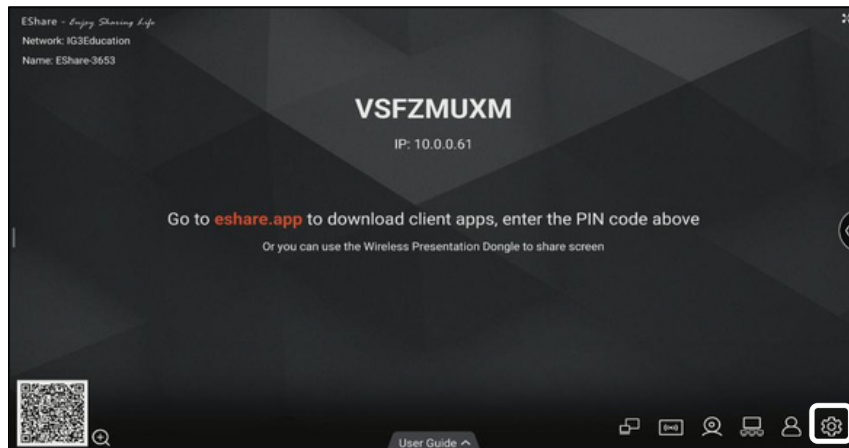

3. The **Settings** dialog box opens.

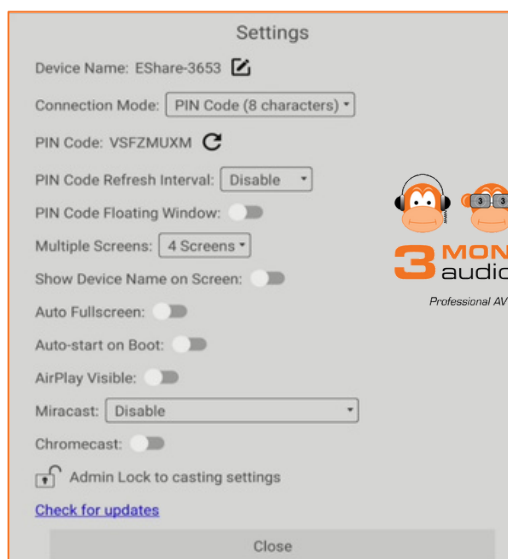

The following settings can be updated:

Field Name	Description
Device Name	EShare's device name for the panel. This name can be changed.
Connection Mode	Select the connection mode, either the Device Name, or a 6 digit or 8-character PIN code.
Pin Code	Displays the current PIN Code.

PIN Code Refreshing Interval	The PIN Code Refreshing Interval is the time the PIN Code refreshes. The options are Disable, 10 minutes, 30 minutes, 1 hour or 1 day.
PIN Code Floating Window	Slide to On to display the Pin Code on the screen. The code can be located on the Side Panel.
Multiple Screens	Select how many screens can share simultaneously. The options are Disable, 2 Screens, 4 Screens, 6 Screens, 9 Screens or 16 Screens.
Show device name on Screen	Displays the device name on the screen.
Auto Fullscreen	Opens the Share Screen as a full screen.
Auto-start on Boot	Will automatically start when panel starts.
AirPlay Visible	Slide to On to allow a device to directly connect to the panel using Apple AirPlay. Note: Touch is not supported with AirPlay devices.
Miracast	Choose Disable, Enable AGO-mode or Enable NGO-mode. Miracast allows Intel devices running Windows to directly connect to the panel. Note: Touch is not supported with Miracast devices.
Chromecast	Slide to On to allow a device to directly connect to the panel using Chromecast. Note: Touch is not supported with Chromecast devices.
Admin to lock casting settings	The Panel's admin can lock the various casting settings.

Note: If the Pin Code is displayed on the panel, Settings can also be accessed by double tapping the Pin Code.

Moderator Control Center

The Moderator Control Center controls connected device's access permissions and displays the connected devices.

To display the Moderator Control Center:

- From the EShare Wireless Projection Home screen, tap the **Floating Moderator Button** on the bottom right-hand side of the screen.

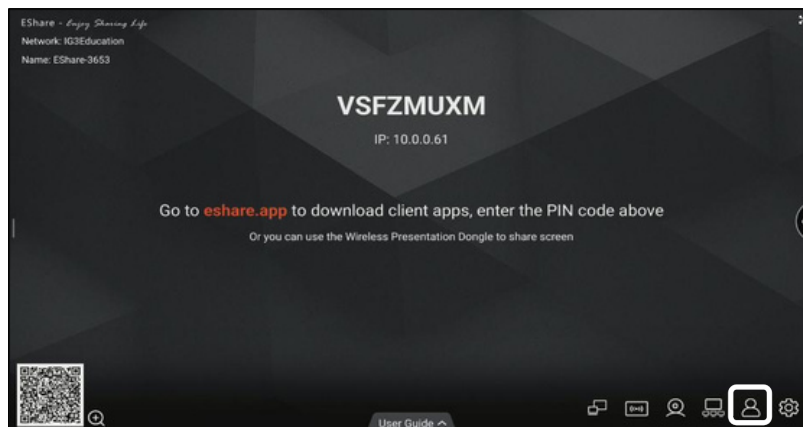

Or,

- Tap the **Floating Moderator Button** on the right-hand side of the EShare Wireless Projection Home screen.

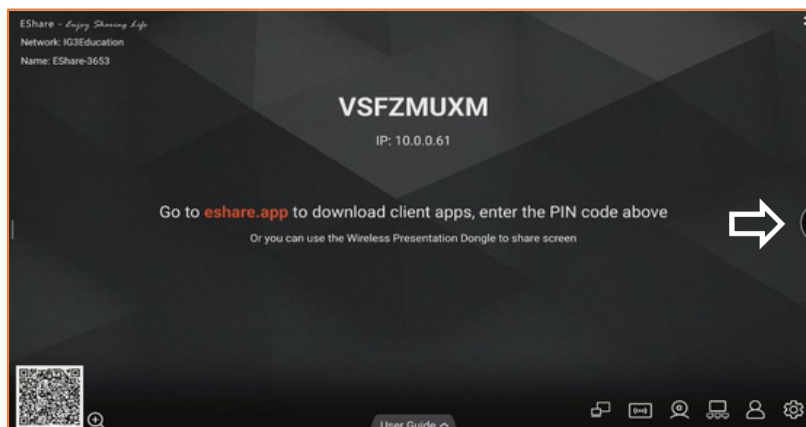

- The Moderator Control Center opens.



Field Name	Description
Share Screen or File	<p>When enabled, any device wishing to access the panel must be either accepted or rejected by the presenter.</p> <p>Available options are: All allowed, Need authorization, Disable</p>
View, Control and Wireless Annotation	<p>When enabled, any device wishing to view the panel's contents on their device must be either accepted or rejected by the presenter.</p> <p>Available options are: All allowed, View only, Need authorization, Disable</p>
Floating Moderator Button	<p>Displays the Floating Moderator Button options: Always display, Only on the Home screen, Disable, Auto</p>

Displaying Connected Devices

A list of connected devices is located on the Moderator Control Center. The presenter can see whether a connected device is screen sharing onto the panel or TV Mirroring from the panel onto the device.

Up to 16 devices can be displayed simultaneously and up to 50 devices can be connected.

To display the connected devices:

1. Open the **Moderator Control Center** (*refer to page 35 for information*).

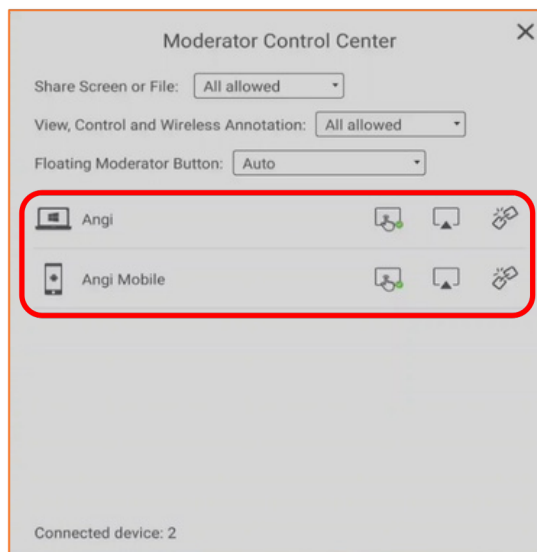

2. All connected devices are displayed.
3. The presenter can select which devices can Share Screen, TV Mirror or disconnect.

Display Group Settings

Display Group Settings enables the display of one panel to be displayed upon all panels in the group.

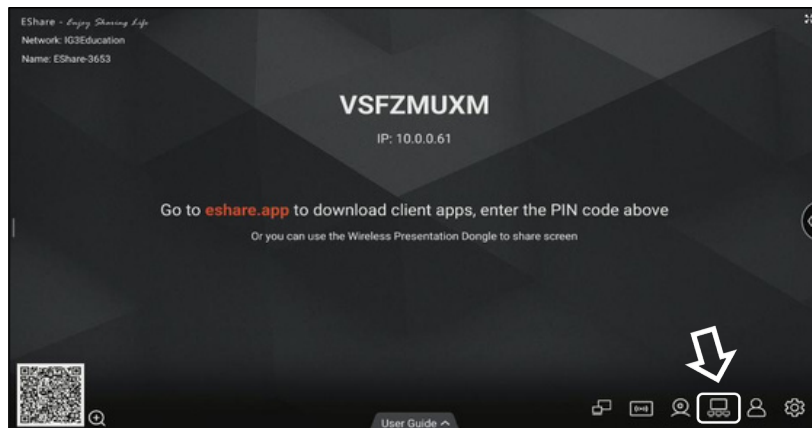

BYOM

The BYOM service uses a webcam connected to the panel and a laptop's microphone to host meetings on your laptop.

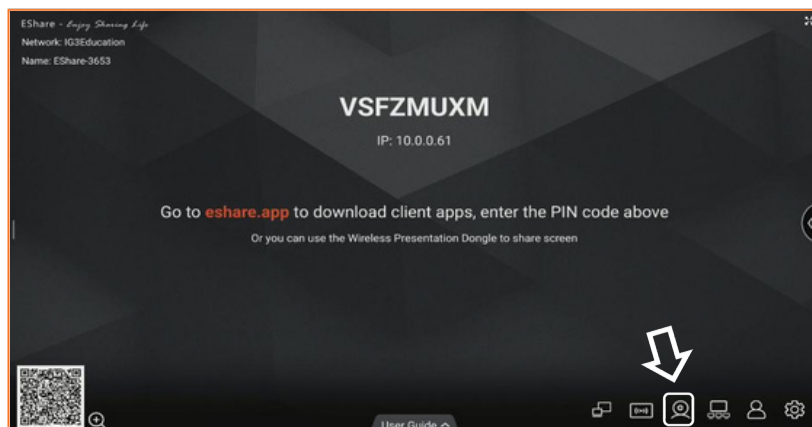

Cloud Broadcast

With Cloud Broadcast enabled, the EShare screen can be viewed through a web browser on the laptop.

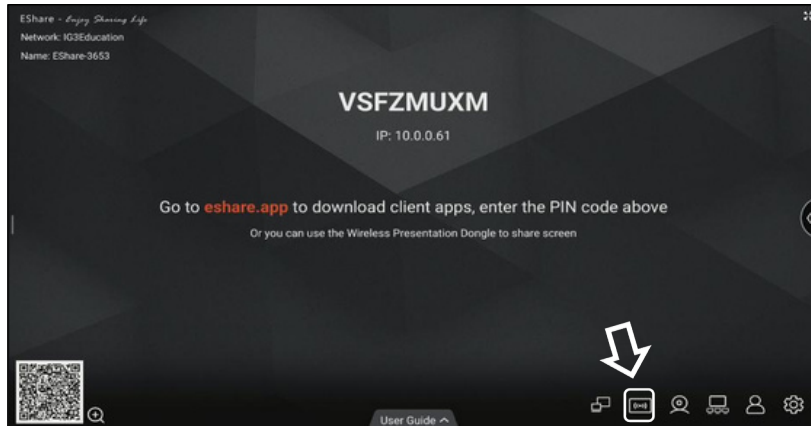

WebCast

Enabling Webcast allows visitors to share their screen through the web browser on their laptop.

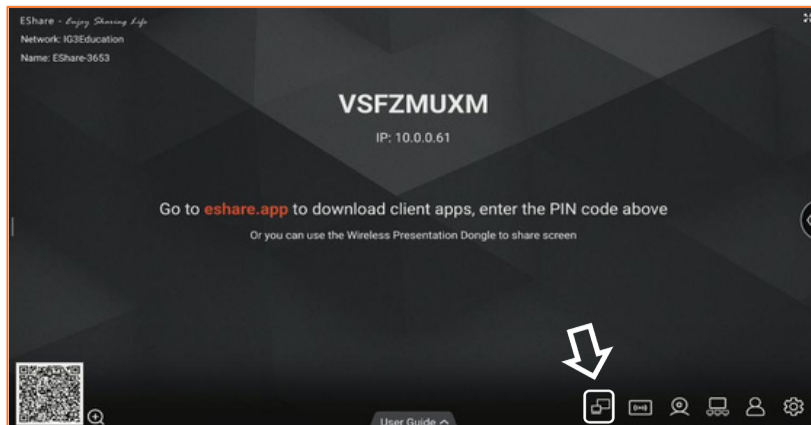

Using EShare with a Laptop / Desktop

Laptop and Desktop devices use the EShare client to connect wirelessly with the panel.

There are three available functions:

1. Share Screen
2. Extend Screen Mode
3. TV Mirror

Installing EShare Client on a Laptop or Desktop

EShare requires network access and must be installed on all devices using it to connect to the panel.

To install EShare on a Windows or Mac laptop/desktop device:

1. From the panel's Home Screen, tap **EShare** to display the EShare Wireless Projection Home Screen.

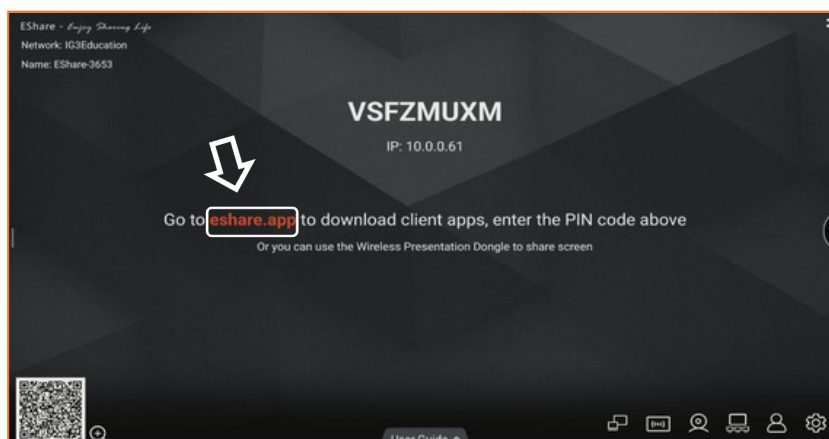

2. To install EShare on a Windows or Mac laptop/desktop, enter www.eshare.app into a browser.
3. From the EShare Download screen, select the appropriate option.
4. EShare installs and places an icon on the device's desktop.

Note: EShare is also available on <https://ig3education.com.au/support>.

Connecting the Panel and a Laptop/Desktop Device

To connect:

1. Open **EShare** from the device's desktop.
2. Click **Connect**.

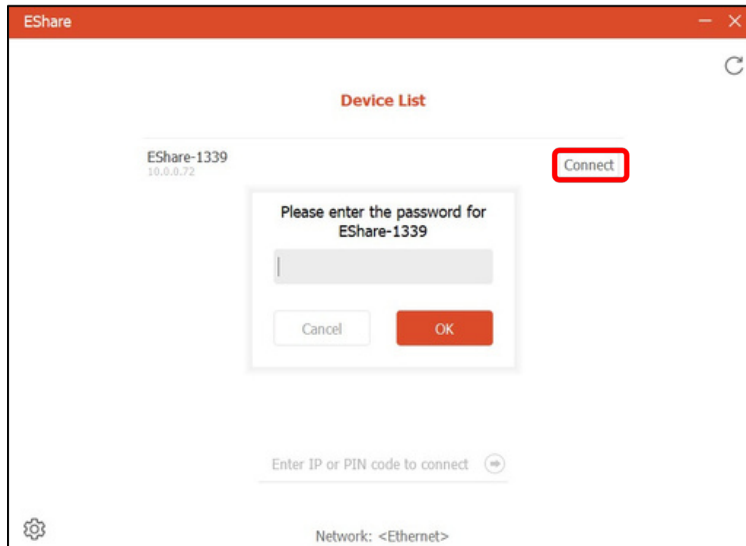

3. Enter the connection code displayed on the panel.
4. Click **OK**.

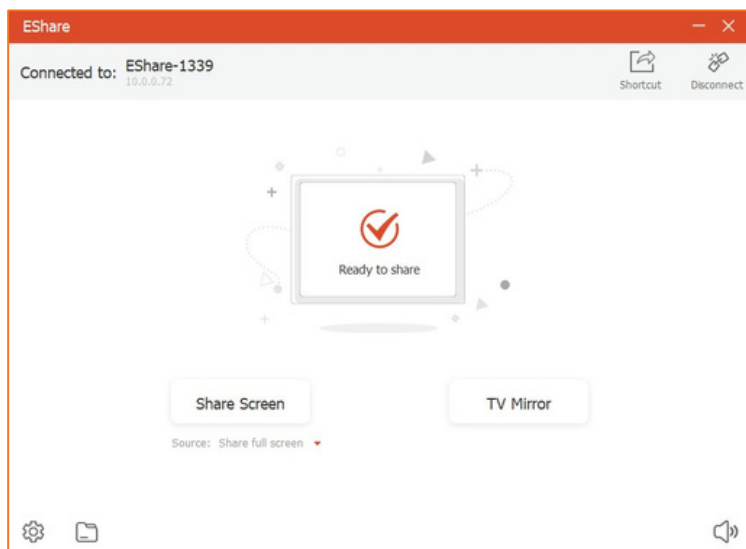

5. The panel and the laptop/desktop are connected.
6. Select either Share Screen (to share the contents of the device onto the panel) or TV Mirror (to display the contents of the panel onto the device).

****Note: The Floating window can be moved across the top of the panel.**

Share Screen

Share Screen projects the contents of a laptop or desktop onto the panel. Applications, documents, pictures, videos, and audio can be projected. Laptop and desktop devices use touch on the panel to control what is being projected.

To share a laptop or desktop's screen on the panel:

1. Connect the panel and the laptop/desktop device (**refer to page 41 for information**).
2. On the laptop or desktop, select **Share Screen**.

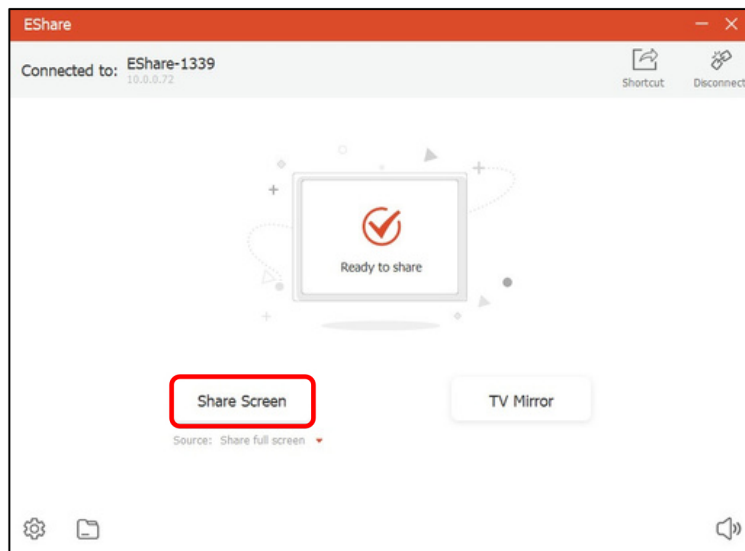

3. On the panel, if Need authorization has been turned on in the **Screen Share or File** drop-down list in the Moderator Control Center, a pop-up message displays on the panel requesting that the presenter either **Deny** or **Allow** the share.
4. The laptop or desktop's screen contents are mirrored onto the panel.

To stop screen sharing:

1. On the laptop or desktop device, access EShare.
2. Click the **Stop Sharing** icon .
3. Close EShare by clicking on the **X** in the top right-hand corner.

Extend Screen Mode

Extended Screen Mode projects a file or an application onto the panel and a different application or file on the laptop or desktop device.

To run extended screen mode:

1. Connect the panel and the laptop/desktop device (*refer to page 41 for more information.*)
2. In the Share Screen drop-down list, select **Shareextend screen.**

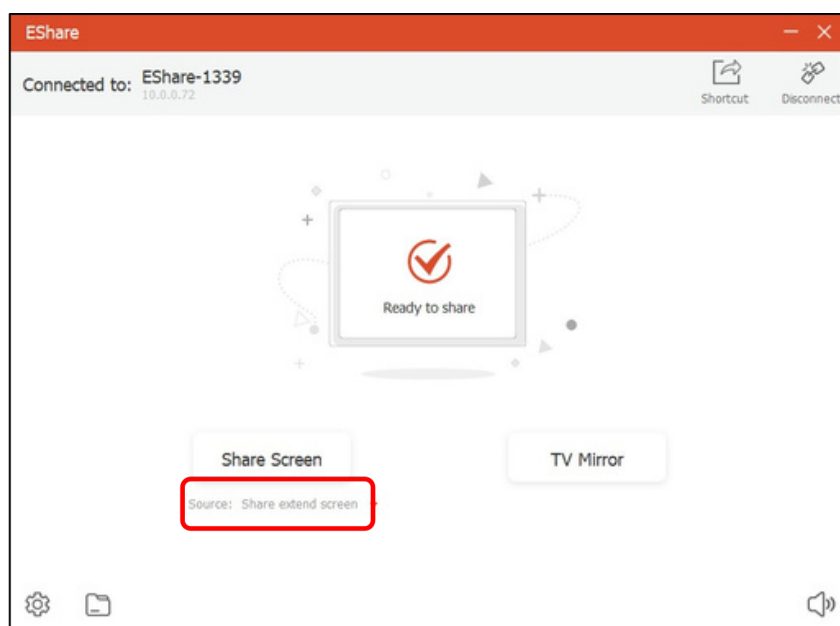

3. On the panel, if Need authorization has been turned on in the **Screen Share or File** drop-down list in the Moderator Control Center, a pop-up message displays on the panel requesting that the presenter either **Deny** or **Allow** the share.
4. On the laptop/desktop, open the file to be displayed on the panel.
5. Slide the file to the right and onto the panel.

To stop extended screen mode:

1. On the laptop or desktop device, access EShare.
2. Click the **Stop Sharing icon** 
3. Close EShare by clicking on the **X** in the top right-hand corner.

Note: The Extend Screen Mode is only available on laptops and desktops.

TV Mirror

TV Mirror projects the contents of the panel's screen onto a laptop or desktop device. To project the panel's screen:

1. Connect the panel and the laptop/desktop device (**refer to page 41 for more information**).
2. On the device, select **TV Mirror**.

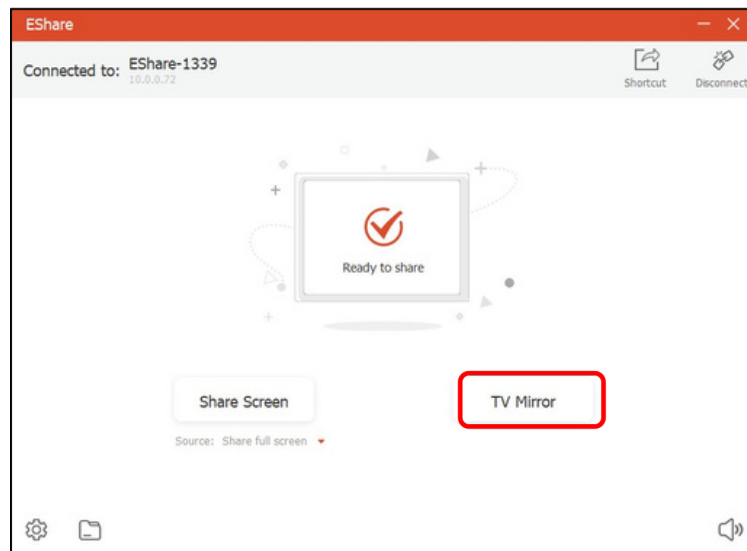

3. On the panel, if Need authorization has been turned on in the **View, Control and Wireless Annotation** drop-down list in the Moderator Control Center, a pop-up message displays on the panel requesting that the presenter either **Deny** or **Allow** the view via TV Mirror.
4. The contents of the panel's screen are projected onto the device.

To annotate on the panel:

1. On the TV Mirror Side Bar, select the **Pen** icon to activate the Annotation Tool.

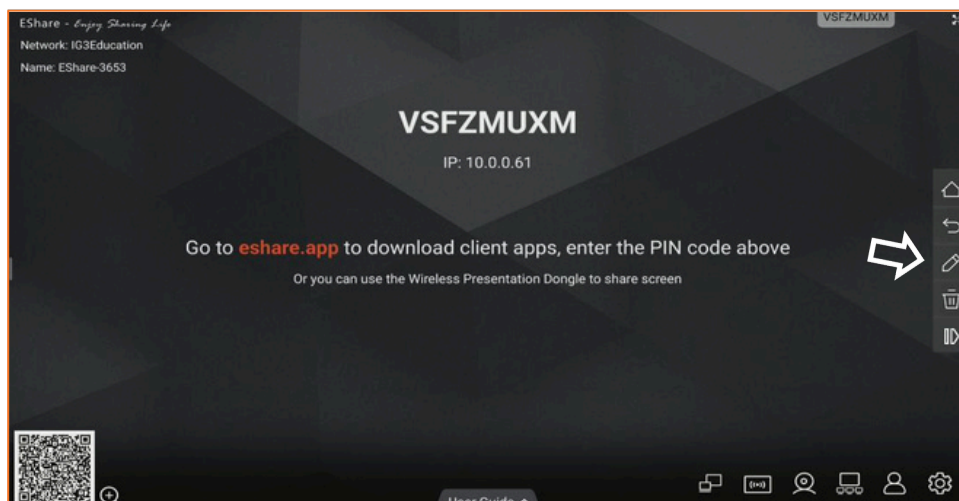

To stop TV Mirror and disconnect the Panel and the device:

1. On the laptop or desktop device, access EShare.
2. Tap **Disconnect** in the top right-hand corner of the EShare dialog box.

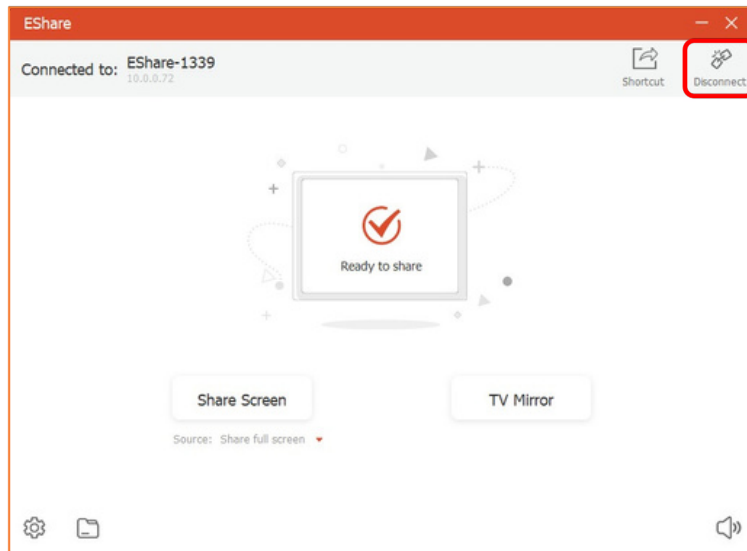

3. Close EShare by clicking on the **X** in the top right-hand corner.

Using EShare with a Mobile Device

EShare connects mobile phones, iPads, and tablets to the panel. There are seven available functions:

1. Share Screen (Device Mirroring)
2. TV Mirror
3. Photo
4. Audio/Video
5. Doc
6. Camera
7. Remote

Note: The screenshots were captured on an Android and an iPhone mobile phone. Screen displays and some action steps may vary slightly.

Installing EShare Client on a Mobile Device

EShare requires network access and must be installed on all devices connecting to the panel.

To install EShare on a Mobile device:

1. From the panel's Home Screen, tap **EShare** to display the EShare Home Screen.

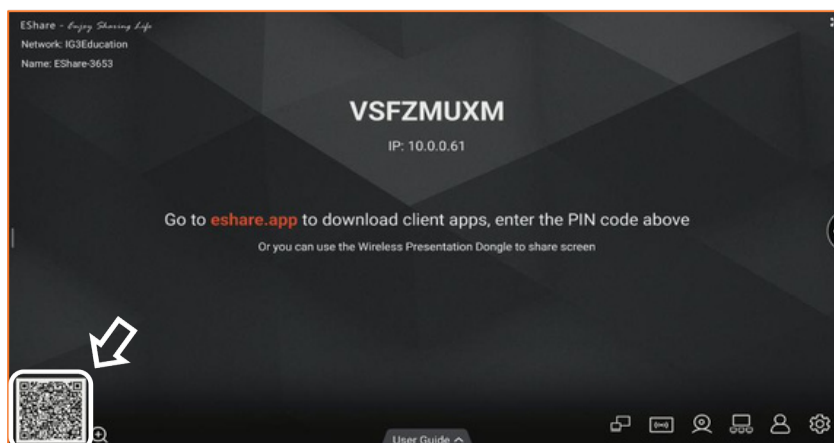

2. On a mobile device, scan the QR code or download EShare from the App Store.
3. The EShare Download screen is displayed. Select the appropriate option.
4. The EShare app is automatically installed onto the mobile device.

Connecting the Panel and a Mobile Device

EShare requires network access and all devices must be connected to the same subnet.

To connect:

1. Open **EShare** on the mobile device.
2. On the EShare sign-in screen, enter the connection code displayed on the panel

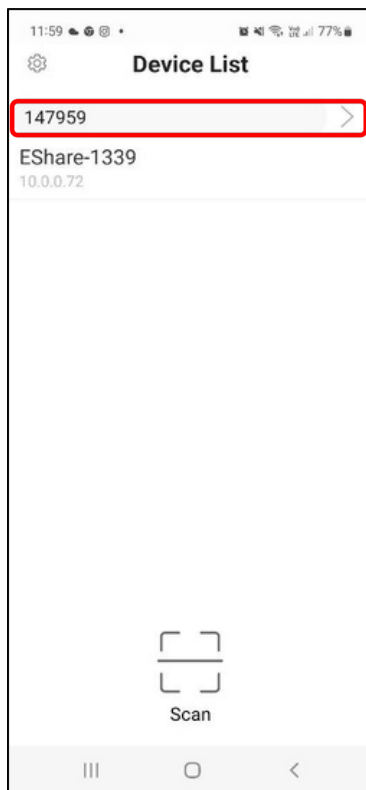

Android



Apple

3. The panel and the mobile device are connected.

Share Screen

Share Screen mirrors the display of a mobile device onto the panel.
To share a device's screen:

1. When the panel and the mobile device are connected (**refer to page 46 for more information**), select **Share Screen** to start sharing the device's display onto the panel.

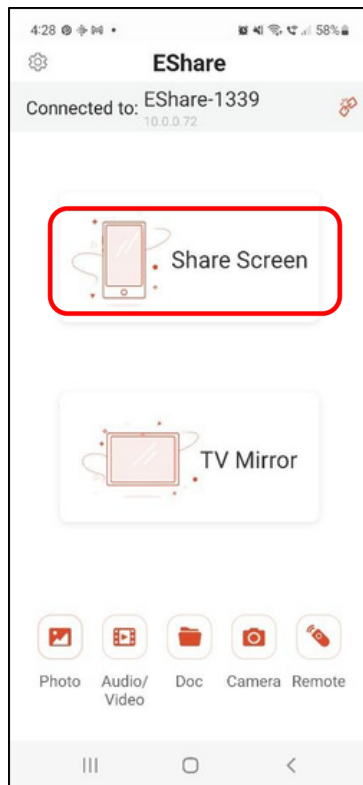

Android

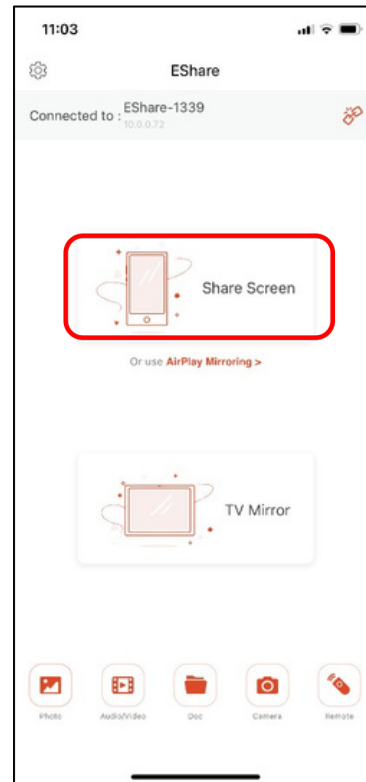

Apple

2. On the panel, if Need authorization has been turned on in the **Screen Share or File** drop-down list in the Moderator Control Center, a pop-up message displays on the panel requesting that the presenter either **Deny** or **Allow** the share.
3. A pop-up dialog box displays confirming EShare will have access to the information that is displayed on the device.



Android

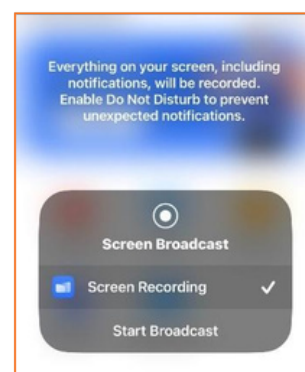

Apple

4. Tap **Start Now** on the Android device and **Start Broadcast** on the Apple device.
5. The contents of the mobile device are mirrored onto the panel.

To stop screen sharing:

1. On the mobile device, return to EShare's main interface.
2. Tap **Stop Sharing**.

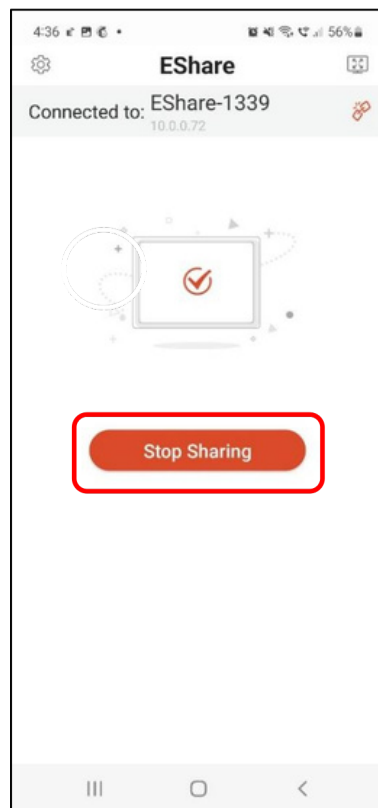

Android

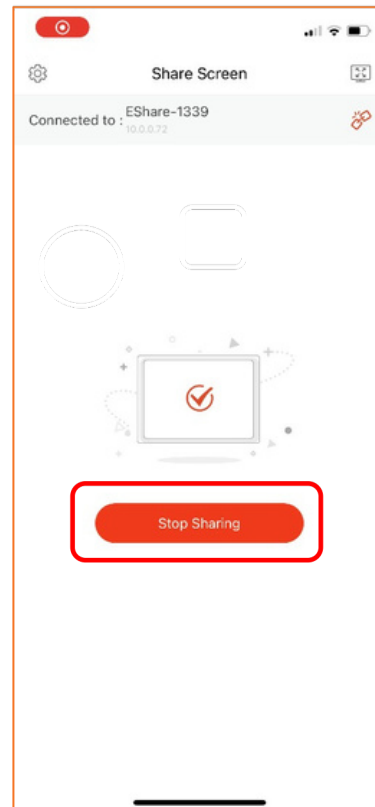

Apple

3. On the Apple device, tap **Stop Broadcasting**.
4. EShare's mobile device Home Screen displays.

TV Mirror

TV Mirror projects the contents of the panel's display onto a mobile device. To project the panel's screen:

1. On the mobile device, tap **TV Mirror** on the EShare's main interface.

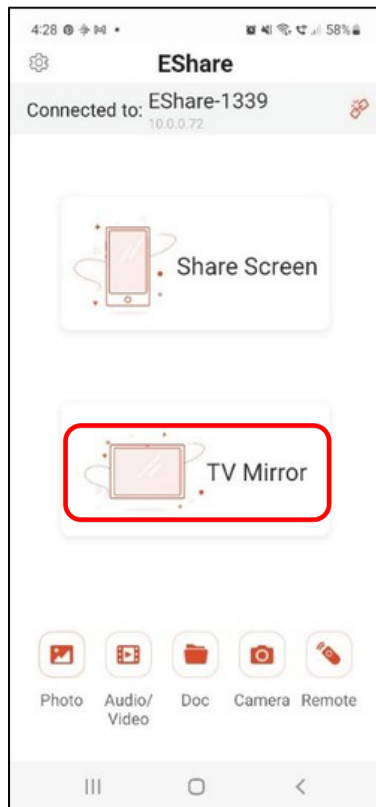

Android









Apple

2. On the panel, if Need authorization has been turned on in the **View, Control and Wireless Annotation** drop-down list in the Moderator ControlCenter, a pop-up message displays on the panel requesting that the presenter either **Deny** or **Allow** the view via TV Mirror.



3. The panel's display is mirrored onto the mobile device.

4. The EShare TV Mirror Toolbar displays on the right-hand side of the screen:

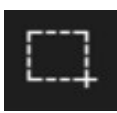
Feature	Description
	Displays the Panel's Home Screen.
	Returns BACK to the previous screen.
	Accesses photos, audio, video and documents on the phone and apps on the panel.
	Enables Touch.
	Annotate.
	Removes Annotations.
	Opens the Camera. The photo is stored on the phone's camera gallery.
	Saves the panel's display as photo on the phone's camera gallery.

To stopTV Mirror:

1. Tap the **X** icon on the upper left-hand corner of the mobile device to return to EShare's main interface.



Photo

The Photo icon projects a photo from the mobile device's photo gallery onto the panel.

To project a photo:

1. On the mobile device, tap **Photo** on the EShare's main interface.



Android

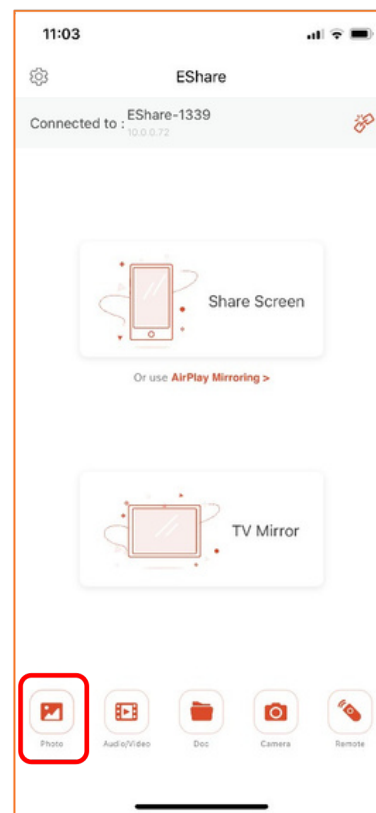

Apple

2. The device's photo gallery is displayed.
3. Select the photo to project.
4. On the panel, if Need authorization has been turned on in the **Screen Share** or **File** drop-down list in the Moderator Control Center, a pop-up message displays on the panel requesting that the presenter either **Deny** or **Allow** the share.

To stop projecting the photo onto the panel:

1. Tap the back arrow in the top-left hand side of the mobile device to return to the device's photo gallery.
2. Tap it again to return to EShare's main interface.

Audio/Video

The Audio/Video icon plays a video or audio file stored on the mobile device onto the panel.

To play a media file:

1. On the mobile device, tap **Audio/Video** on the EShare's main interface.
2. On the panel, if Need authorization has been turned on in the **Screen Share or File** drop-down list in the Moderator Control Center, a pop-up message displays on the panel requesting that the presenter either **Deny** or **Allow** the share.

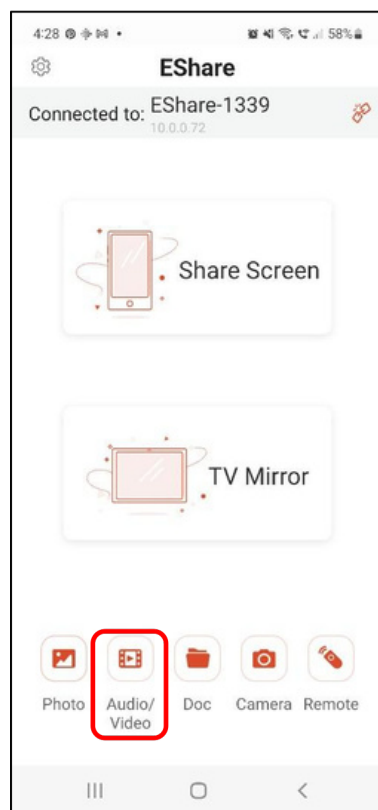

Android

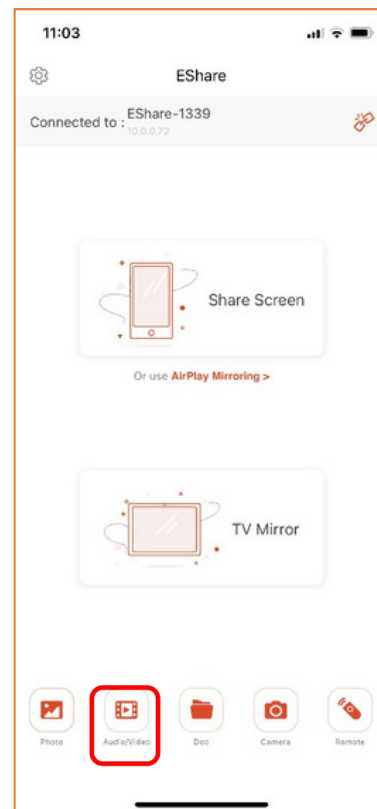

Apple

2. Select the **Video** or **Audio** tab displayed on the top of the screen.
3. Select the media file to play on the panel.

To stop projecting the Audio/Video onto the panel:

1. Tap **Stop** to return to the media files.
2. Tap the back arrow in the top left-hand side to return to EShare's main interface.

Doc

DOC, DOCX, PPT, PPTX, XLS, XLSX and PDF documents can be displayed from the mobile device onto the panel.

To display a document:

1. On the mobile device, tap **Doc** on EShare's main interface.



Android

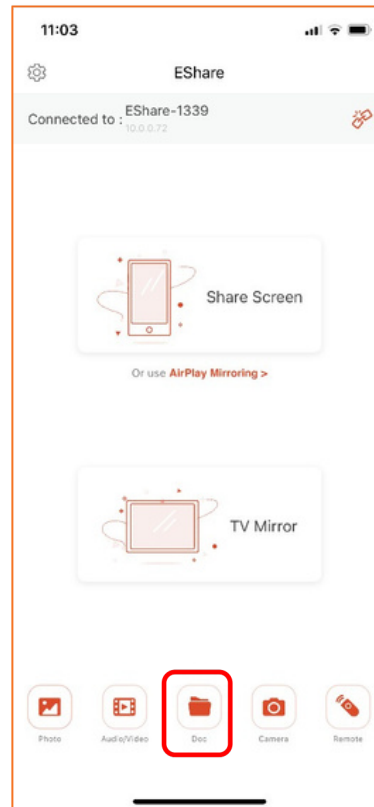

Apple

2. The documents list displays.
3. Tap the document to display.
4. On the panel, if Need authorization has been turned on in the **Screen Share or File** drop-down list in the Moderator Control Center, a pop-up message displays on the panel requesting that the presenter either **Deny** or **Allow** the share.
5. The document is displayed on the panel in WPS Office.
6. The Remote function is enabled on the mobile device to manage the document.
(Refer to page 56 for more information.)

To stop projecting a document to the panel:

1. On the device, tap the **Home** icon to return to the panel's Home Screen.
2. Tap the back arrow in the top left-hand side to return to the Document list.
3. Tap the back arrow in the top left-hand side to return to EShare's main interface.

Camera

Selecting the camera icon allows the mobile device's camera to take a photo and project it directly onto the panel.

To take a photo:

1. On the mobile device, tap **Camera** on EShare's main interface.

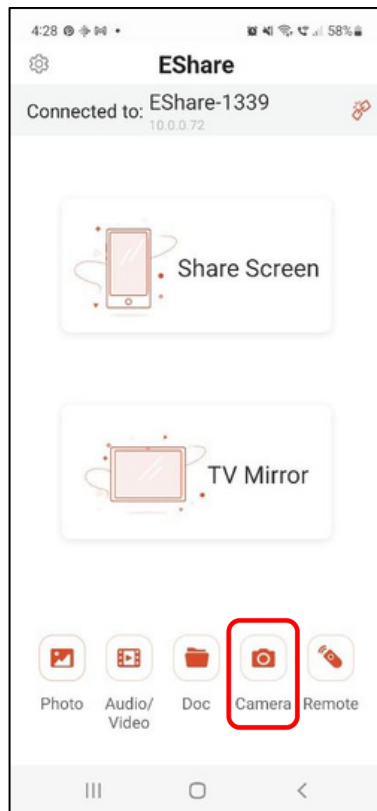

Android

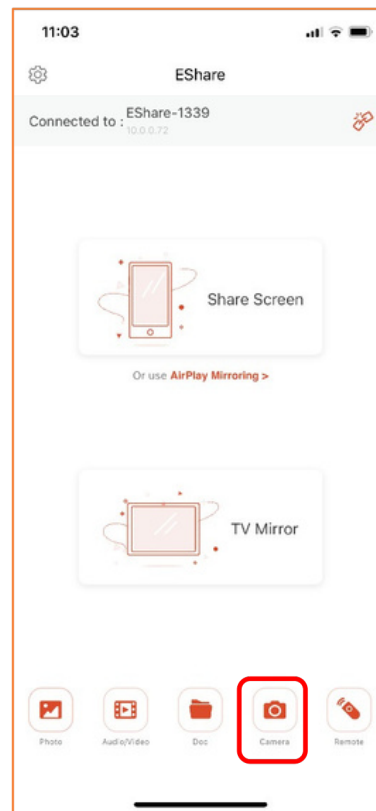

Apple

2. The device's camera is activated.
3. On the panel, if Need authorization has been turned on in the **Screen Share** or **File** drop-down list in the Moderator Control Center, a pop-up message displays on the panel requesting that the presenter either **Deny** or **Allow** the share.
4. Tap the white button in the bottom centre of the device to take a photo. The photo is displayed on the panel.
5. Tap the camera icon to continue taking photos.
6. On the top right-hand side, tap the red cross on the Android device and the red arrow on the Apple device to return to EShare's main interface.

Note: The photos are saved in the **Pictures** gallery on the Android and Apple devices.

Remote

Remote allows the mobile device to act like a wireless mouse and control the panel.
To activate the remote:

1. On the mobile device, tap **Remote** on EShare's main interface.



Android



Apple

2. On the panel, if Need authorization has been turned on in the **Screen Share or File** drop-down list in the Moderator Control Center, a pop-up message displays on the panel requesting that the presenter either **Deny** or **Allow** the share.
3. The Remote function opens on the mobile device.

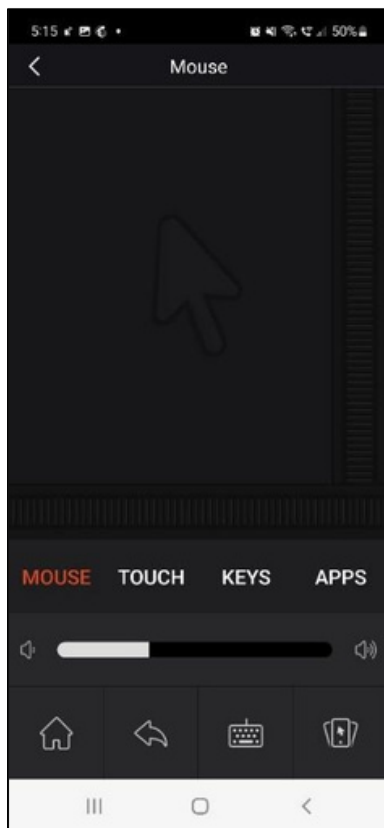

Android

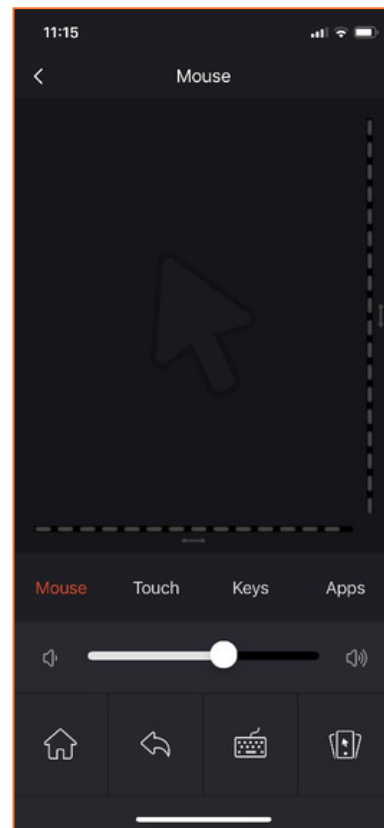

Apple

4. The mobile device displays eight options on the bottom of the screen:
- **Mouse** - the device's display is used as a mousepad.
 - **Touch** –The device's display is used to run touch on the panel.
 - **Keys** – can customise 2 shortcut keys to quickly access an App.
 - **Apps** – opens a screen displaying all Apps. Double tap an App to run it.
 - **Home** - return to Panel's Home Screen.
 - **Back** – goes back to the previous screen.
 - **Keyboard** – displays a keyboard.
 - **Air Mouse** – uses the device like a pointer.
5. Tap the back arrow in the top left-hand side of the mobile device to return to EShare's main interface.

Disconnecting the Panel and a Mobile Device

To disconnect the mobile device from the panel:

1. On the mobile device, tap the **Disconnect** icon in the top right-hand corner of EShare's main interface.



Android

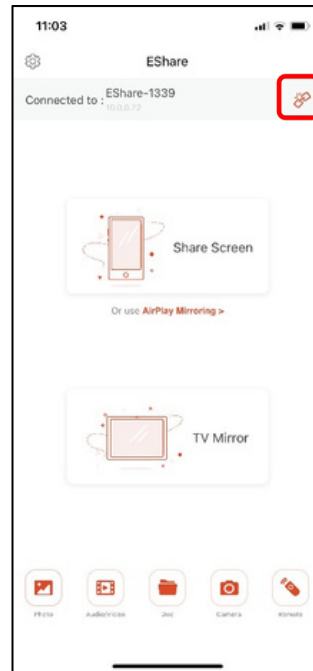

Apple

2. EShare's sign in screen displays on the mobile device.



Android



Apple

3. Close EShare on the device

Screen Sharing using Apple AirPlay

To mirror the device using AirPlay:

1. From the Apple **Control Centre**, tap the **Screen Mirroring** icon.

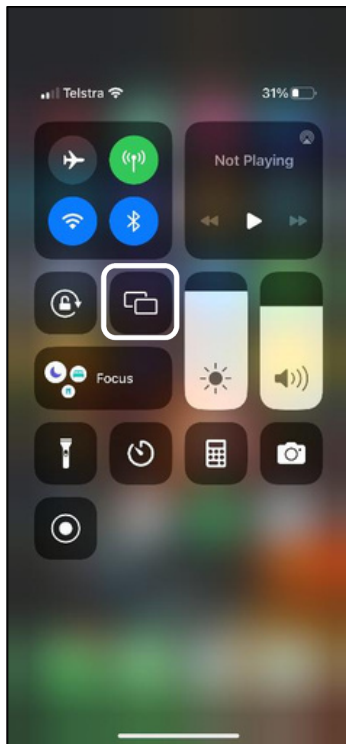

2. The Screen Mirroring pop-up displays a list of available screen mirroring devices.

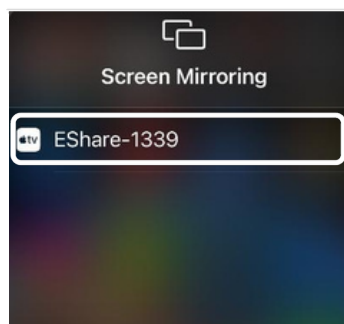

3. Tap an **“Available Device”** to select it and display a tick.

4. Enter the AirPlay Code.

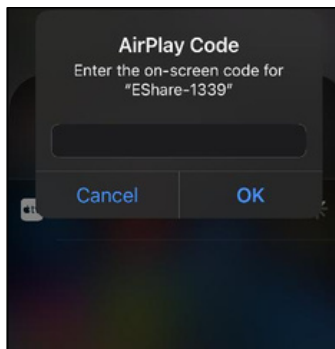

5. Tap **OK**.

6. Click away to display the **Control Center**.

7. Click away to project the device's display onto the panel.

To stop mirroring using AirPlay:

1. On the Apple device, open the **Control Centre** and tap the **Screen Mirroring** icon. The Screen Mirroring pop-up displays a list of available screen mirroring devices.

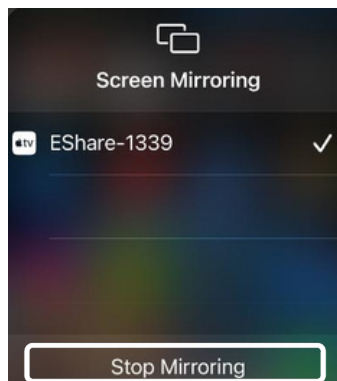

2. Tap **Stop Mirroring**.

Appendix B – Adding Additional Users

The panel can be shared amongst multiple users. Each user has their own space which can be customised with apps, wallpaper, etc.

To add additional users:

1. From the Android Control Panel, touch the **Add User** icon.

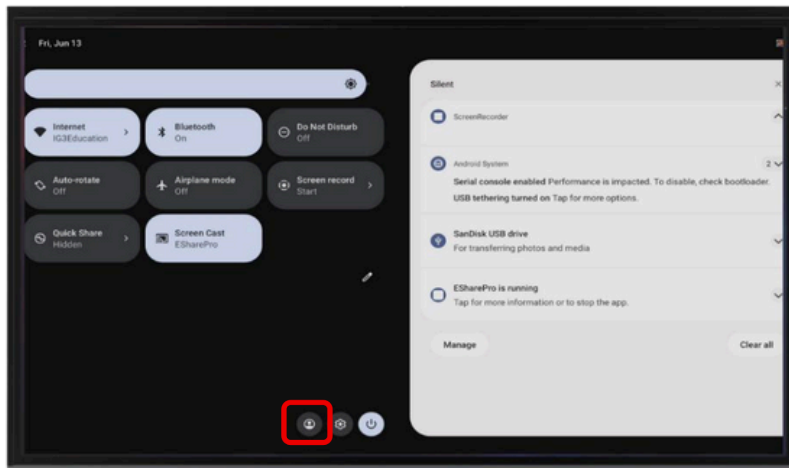

2. Touch **User settings** to add a new user.

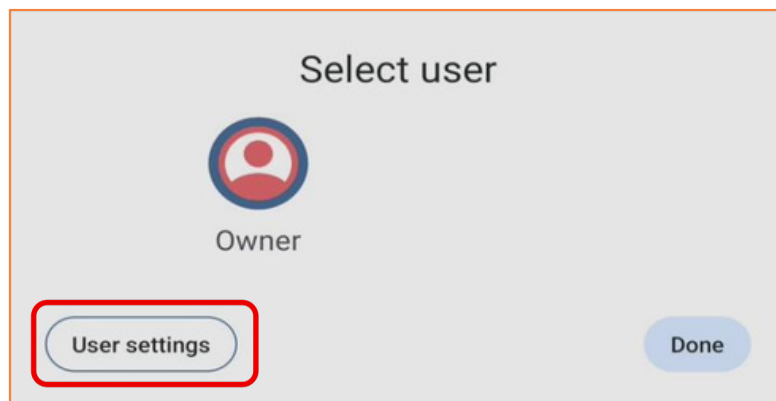

3. Edit an existing user by adding NFC, add a guest account or new a user.

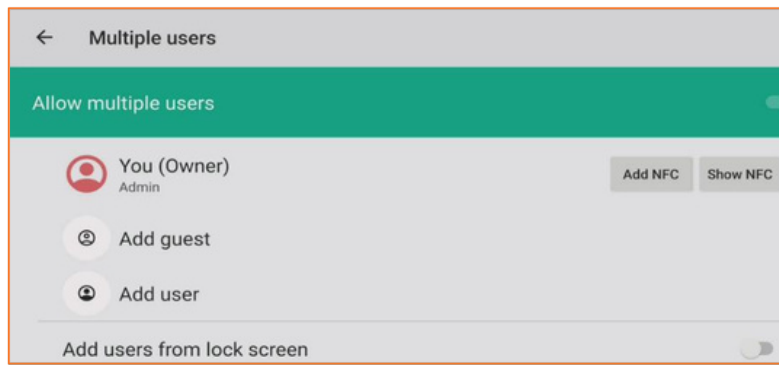

4. Enter the new User's name. Once logged in, their space can be customised.



3 MONKEYS
audiovisual
PTY LTD

P: 08 9228 1681

E: support@3monkeysav.com

W: www.3monkeysav.com.au